

**This electronic collection of documents is provided
for the convenience of the user
and is Not a Certified Document –**

**The documents contained herein were originally issued
and sealed by the individuals whose names and license
numbers appear on each page, on the dates appearing
with their signature on that page.**

**This file or an individual page
shall not be considered a certified document.**

09/08/99

28-AUG-2017 13:45 S:\Dis+3\DN00605_EB-5759_PenielRd_Sidewalk_Columbus;Polk County\POLK\PolkCounty-ADA\dgn\RDWY_sht4.dgn orbrown4 AT DIV14-297484

CONTRACT: DN00605 FEDERAL ID TAP-1377(010) WBS ELEMENT: 50436.3.1

See Sheet 1-A For Index of Sheets

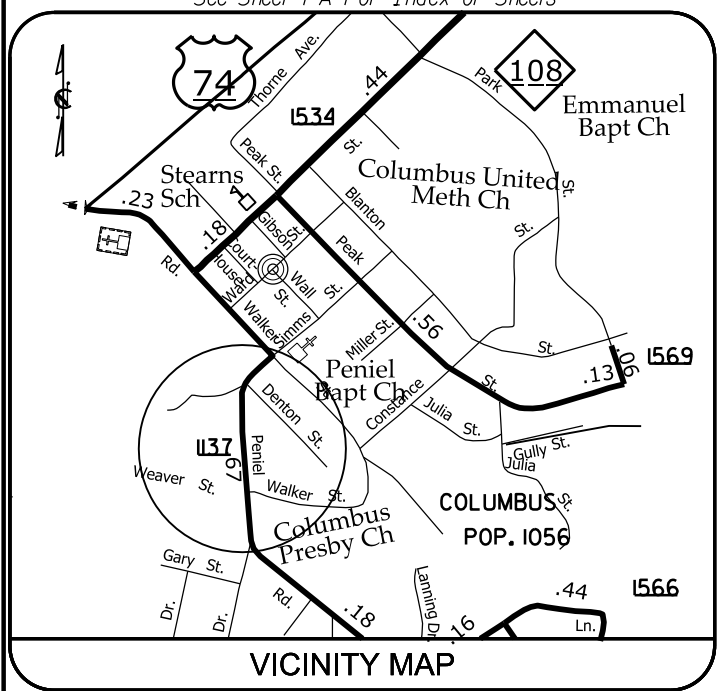

STATE OF NORTH CAROLINA
DIVISION OF HIGHWAYS

POLK COUNTY

LOCATION: ALONG SR-1137 PENIEL ROAD FROM THE INTERSECTION WITH WALKER ST. TO INTERSECTION WITH WHEELER ST.

TYPE OF WORK: TRAFFIC CONTROL, CONCRETE SIDEWALK, CONCRETE DRIVEWAY TURNOUT

STATE	STATE PROJECT REFERENCE NO.	SHEET NO.	TOTAL SHEETS
N.C.	EB-5759	1	
STATE PROJ. NO.	F.A. PROJ. NO.	DESCRIPTION	
50436.1.1		PE	
50436.3.1		Construction	

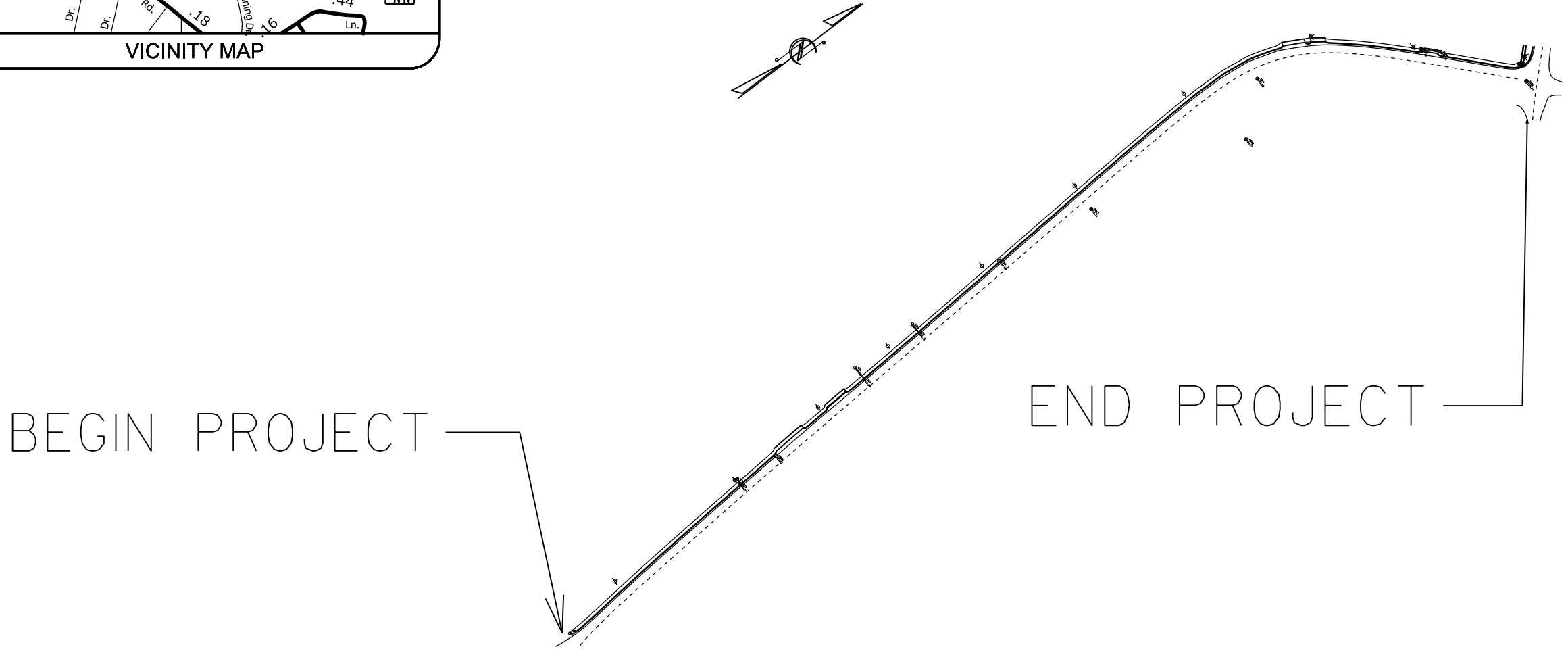

Note: All work shall be completed with in existing Right of Way

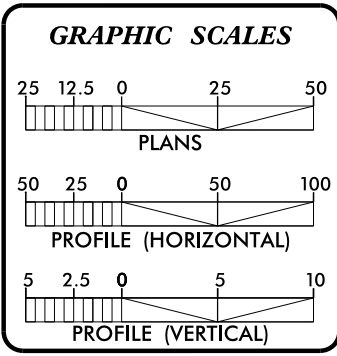

PROJECT LENGTH

0.31 MILES

Prepared In the Office of:
DIVISION OF HIGHWAYS
191 Robbinsville Rd., Andrews NC, 28901

2012 STANDARD SPECIFICATIONS	
RIGHT OF WAY DATE: August 30, 2017	STEVE CANNON PE PROJECT ENGINEER
LETTING DATE: October 24, 2017	ALAN R BROWN PROJECT DESIGN ENGINEER

HYDRAULICS ENGINEER

SIGNATURE: P.E.

ROADWAY DESIGN ENGINEER

SIGNATURE: P.E.

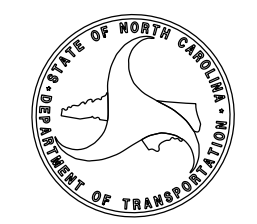

STATE OF NORTH CAROLINA
DIVISION OF HIGHWAYS

INDEX OF SHEETS

- | | |
|-----|--|
| 1 | TITLE SHEET |
| 2 | INDEX OF SHEETS, GENERAL NOTES AND LIST OF STANDARDS |
| 3 | CONVENTIONAL SYMBOLS |
| 4-7 | PLAN SHEETS |

GENERAL NOTES

- GENERAL NOTES: 2012 SPECIFICATIONS
EFFECTIVE: 01-17-2012
- 1 CARE SHALL BE TAKEN TO PREVENT DAMAGE TO EXISTING UTILITIES DURING CONSTRUCTION. ANY DAMAGE TO THESE UTILITIES SHALL BE REPAIRED AT THE CONTRACTOR'S EXPENSE.
 - 2 THE CONTRACTOR SHALL MAINTAIN THE SITE IN A MANNER SO THAT WORKMEN AND PUBLIC SHALL BE PROTECTED FROM INJURY.

LIST OF ROADWAY STANDARDS

- 2012 ROADWAY STANDARD DRAWINGS
- The following Roadway Standards as appear in "Roadway Standard Drawings" - Highway Design Branch - N.C. Department of Transportation - Raleigh, N.C., dated January 17, 2012 and the latest revision thereto are applicable to this project and by reference hereby are considered a part of these plans.
- | STD. NO. | TITLE |
|--|--|
| DIVISION 2 - EARTHWORK | |
| 225.02 | Guide for Grading Subgrade |
| DIVISION 3 - PIPE CULVERTS | |
| 300.01 | Method of Pipe Installation |
| DIVISION 5 - SUBGRADE, BASES AND SHOULDERS | |
| 560.01 | Method of Shoulder Construction |
| DIVISION 6 - ASPHALT BASES AND PAVEMENTS | |
| 654.01 | Pavement Repairs |
| DIVISION 8 - INCIDENTALS | |
| 840.01 | Brick Catch Basin |
| 840.02 | Concrete Catch Basin |
| 840.03 | Frame, Grates and Hood |
| 840.14 | Concrete Drop Inlet |
| 840.15 | Brick Drop Inlet |
| 840.24 | Frame with Grate |
| 846.01 | Concrete Curb, Gutter and Curb & Gutter |
| 848.01 | Concrete Sidewalk |
| 848.02 | DRIVEWAY TURNOUT |
| DIVISION 11 - WORK ZONE TRAFFIC CONTROL | |
| 1101.01 | Detail Drawing for Two Way Undivided Work Zone Warning Signs |
| 1101.02 | Temporary Lane Closures |
| DIVISION 12 - PAVEMENT MARKINGS, MARKERS AND DELINEATION | |
| 1205.01 | Line Types and Offsets |
| DIVISION 16 - EROSION CONTROL AND ROADSIDE DEVELOPEMENT | |
| 1605.01 | Temporary Silt Fence |
| 1606.01 | Special Sediment Control Fence |
| 1631.01 | Matting Installation |

12/05/11

Note: Not to Scale

*S.U.E. = Subsurface Utility Engineering

CONVENTIONAL PLAN SHEET SYMBOLS

BOUNDARIES AND PROPERTY:

Table listing symbols for boundaries and property: State Line, County Line, Township Line, City Line, Reservation Line, Property Line, Existing Iron Pin, Property Corner, Property Monument, Parcel/Sequence Number, Existing Fence Line, Proposed Woven Wire Fence, Proposed Chain Link Fence, Proposed Barbed Wire Fence, Existing Wetland Boundary, Proposed Wetland Boundary, Existing Endangered Animal Boundary, Existing Endangered Plant Boundary, Known Soil Contamination: Area or Site, Potential Soil Contamination: Area or Site.

BUILDINGS AND OTHER CULTURE:

Table listing symbols for buildings and other culture: Gas Pump Vent or U/G Tank Cap, Sign, Well, Small Mine, Foundation, Area Outline, Cemetery, Building, School, Church, Dam.

HYDROLOGY:

Table listing symbols for hydrology: Stream or Body of Water, Hydro, Pool or Reservoir, Jurisdictional Stream, Buffer Zone 1, Buffer Zone 2, Flow Arrow, Disappearing Stream, Spring, Wetland, Proposed Lateral, Tail, Head Ditch, False Sump.

RAILROADS:

Table listing symbols for railroads: Standard Gauge, RR Signal Milepost, Switch, RR Abandoned, RR Dismantled.

RIGHT OF WAY:

Table listing symbols for right of way: Baseline Control Point, Existing Right of Way Marker, Existing Right of Way Line, Proposed Right of Way Line, Proposed Right of Way Line with Iron Pin and Cap Marker, Proposed Right of Way Line with Concrete or Granite R/W Marker, Proposed Control of Access Line with Concrete C/A Marker, Existing Control of Access, Proposed Control of Access, Existing Easement Line, Proposed Temporary Construction Easement, Proposed Temporary Drainage Easement, Proposed Permanent Drainage Easement, Proposed Permanent Drainage / Utility Easement, Proposed Permanent Utility Easement, Proposed Temporary Utility Easement, Proposed Aerial Utility Easement, Proposed Permanent Easement with Iron Pin and Cap Marker.

ROADS AND RELATED FEATURES:

Table listing symbols for roads and related features: Existing Edge of Pavement, Existing Curb, Proposed Slope Stakes Cut, Proposed Slope Stakes Fill, Proposed Curb Ramp, Existing Metal Guardrail, Proposed Guardrail, Existing Cable Guiderail, Proposed Cable Guiderail, Equality Symbol, Pavement Removal.

VEGETATION:

Table listing symbols for vegetation: Single Tree, Single Shrub, Hedge, Woods Line.

Table listing symbols for orchard and vineyard.

EXISTING STRUCTURES:

Table listing symbols for existing structures: MAJOR: Bridge, Tunnel or Box Culvert, Bridge Wing Wall, Head Wall and End Wall; MINOR: Head and End Wall, Pipe Culvert, Footbridge, Drainage Box: Catch Basin, DI or JB, Paved Ditch Gutter, Storm Sewer Manhole, Storm Sewer.

UTILITIES:

Table listing symbols for utilities: POWER: Existing Power Pole, Proposed Power Pole, Existing Joint Use Pole, Proposed Joint Use Pole, Power Manhole, Power Line Tower, Power Transformer, U/G Power Cable Hand Hole, H-Frame Pole, Recorded U/G Power Line, Designated U/G Power Line (S.U.E.*); TELEPHONE: Existing Telephone Pole, Proposed Telephone Pole, Telephone Manhole, Telephone Booth, Telephone Pedestal, Telephone Cell Tower, U/G Telephone Cable Hand Hole, Recorded U/G Telephone Cable, Designated U/G Telephone Cable (S.U.E.*), Recorded U/G Telephone Conduit, Designated U/G Telephone Conduit (S.U.E.*), Recorded U/G Fiber Optics Cable, Designated U/G Fiber Optics Cable (S.U.E.*).

WATER:

Table listing symbols for water: Water Manhole, Water Meter, Water Valve, Water Hydrant, Recorded U/G Water Line, Designated U/G Water Line (S.U.E.*), Above Ground Water Line.

TV:

Table listing symbols for TV: TV Satellite Dish, TV Pedestal, TV Tower, U/G TV Cable Hand Hole, Recorded U/G TV Cable, Designated U/G TV Cable (S.U.E.*), Recorded U/G Fiber Optic Cable, Designated U/G Fiber Optic Cable (S.U.E.*).

GAS:

Table listing symbols for gas: Gas Valve, Gas Meter, Recorded U/G Gas Line, Designated U/G Gas Line (S.U.E.*), Above Ground Gas Line.

SANITARY SEWER:

Table listing symbols for sanitary sewer: Sanitary Sewer Manhole, Sanitary Sewer Cleanout, U/G Sanitary Sewer Line, Above Ground Sanitary Sewer, Recorded SS Forced Main Line, Designated SS Forced Main Line (S.U.E.*).

MISCELLANEOUS:

Table listing symbols for miscellaneous: Utility Pole, Utility Pole with Base, Utility Located Object, Utility Traffic Signal Box, Utility Unknown U/G Line, U/G Tank; Water, Gas, Oil, Underground Storage Tank, Approx. Loc., A/G Tank; Water, Gas, Oil, Geoenvironmental Boring, U/G Test Hole (S.U.E.*), Abandoned According to Utility Records, End of Information.



5' CONCRETE SIDEWALK STD 848.0

WHEEL CHAIR RAMP STD 848.05

11+00

10+00

PENIAL RD SR 1137



NOTE: EROSION CONTROL MEASURES WILL BE AS NEED PER ENGINEERS REQUEST

NOTE: ALL EXPOSED EARTH SURFACES WILL BE SEEDED AND MATTED

MATCHLINE



NOTE: EROSION CONTROL MEASURES WILL BE AS NEEDED PER ENGINEERS REQUEST

NOTE: ALL EXPOSED EARTH SURFACES WILL BE SEEDING AND MATTED

MATCHLINE



NOTE: EROSION CONTROL MEASURES WILL BE AS NEED PER ENGINEERS REQUEST

NOTE: ALL EXPOSED EARTH SURFACES WILL BE SEEDED AND MATTED

ADJUST GAS VALVE TO BE FLUSH WITHIN THE SIDEWALK

5' CONCRETE SIDEWALK STD 848.01

5' CONCRETE SIDEWALK STD 848.01

21+00

20+00

19+00

18+00

17+00

PENIAL RD SR 1137

PENIAL RD SR 1137



WHEEL CHAIR RAMP STD 848.05

PLUG EXISTING DRAINAGE PIPE

BACK FILL SIDE WALK TO DRAIN WATER OVER THE SIDEWALK INTO CURB AND GUTTER

REMOVE EXISTING DRIVEWAY PIPE

5' CONCRETE SIDEWALK STD 848.01

DRIVEWAY TURNOUT STD 848.02

NOTE: EROSION CONTROL MEASURES WILL BE AS NEED PER ENGINEERS REQUEST

PENIAL RD RR 1137

5' CONCRETE SIDEWALK STD 848.01

DRIVEWAY TURNOUT STD 848.02

DRIVEWAY TURNOUT STD 848.02

NOTE: ALL EXPOSED EARTH SURFACES WILL BE SEEDED AND MATTED

5' CONCRETE SIDEWALK STD 848.01

PENIAL RD RR 1137

MATCHLINE

26+50

26+00

25+00

24+00

23+00

22+00